



COMPONENTI MECCANICI
PER ASCENSORI
MECHANICAL LIFT
COMPONENTS

BLOCCO PARACADUTE A
PRESA ISTANTANEA BP2

INSTANTANEOUS SAFETY
GEAR BLOCK BP2

T-243

COD.8024300200 DX/R

COD.8024300201 SX/L

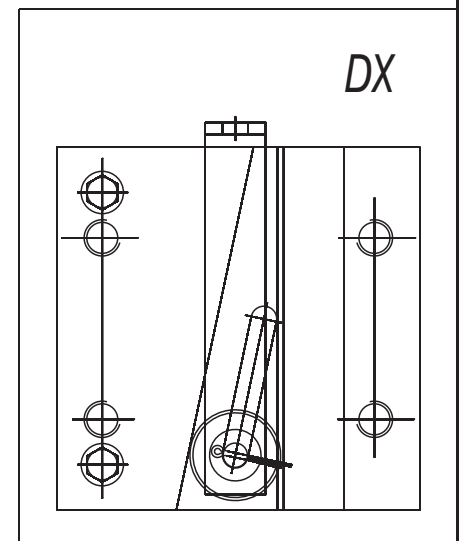
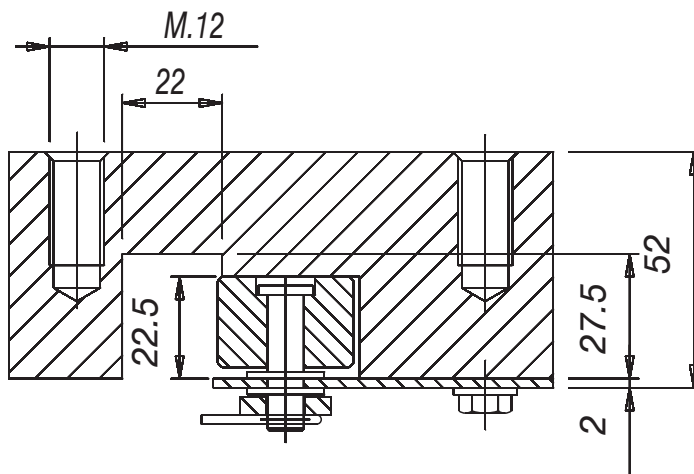
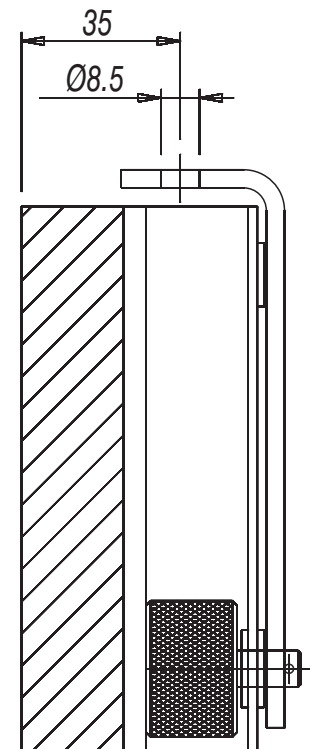
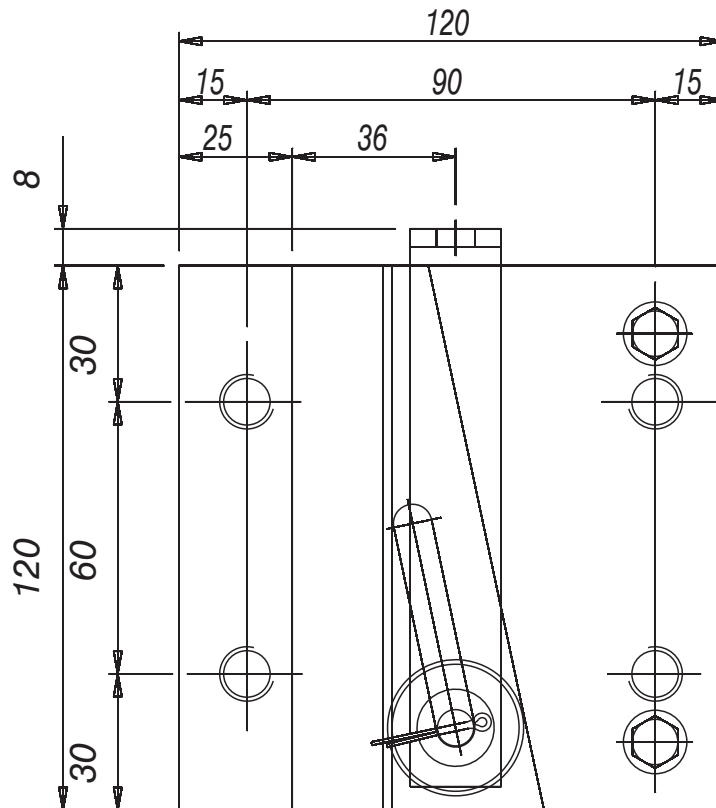

- VERSIONE SINISTRA COME IN FIGURA

DISPONIBILE ANCHE IN VERSIONE DESTRA

- LARGHEZZA GUIDE : 16 mm.

- PESO : 5 Kg.

- PORTATA FINO A 2700 Kg. PER COPPIA

- LEFT VERSION AS DRAWING AVAILABLE

ALSO RIGHT VERSION

- FOR GUIDES : 16 mm.

- WEIGHT : 5 Kgs.

- LOAD UP TO 2700 Kgs. FOR PAIR